

**EFC SINGLE PURGE, SINGLE GUN
MANIFOLD ASSEMBLY
536M40**

**SEE FIGURE 31 FOR
ROBOT AND
RECIPRICATING
MOUNTING BRACKETS**

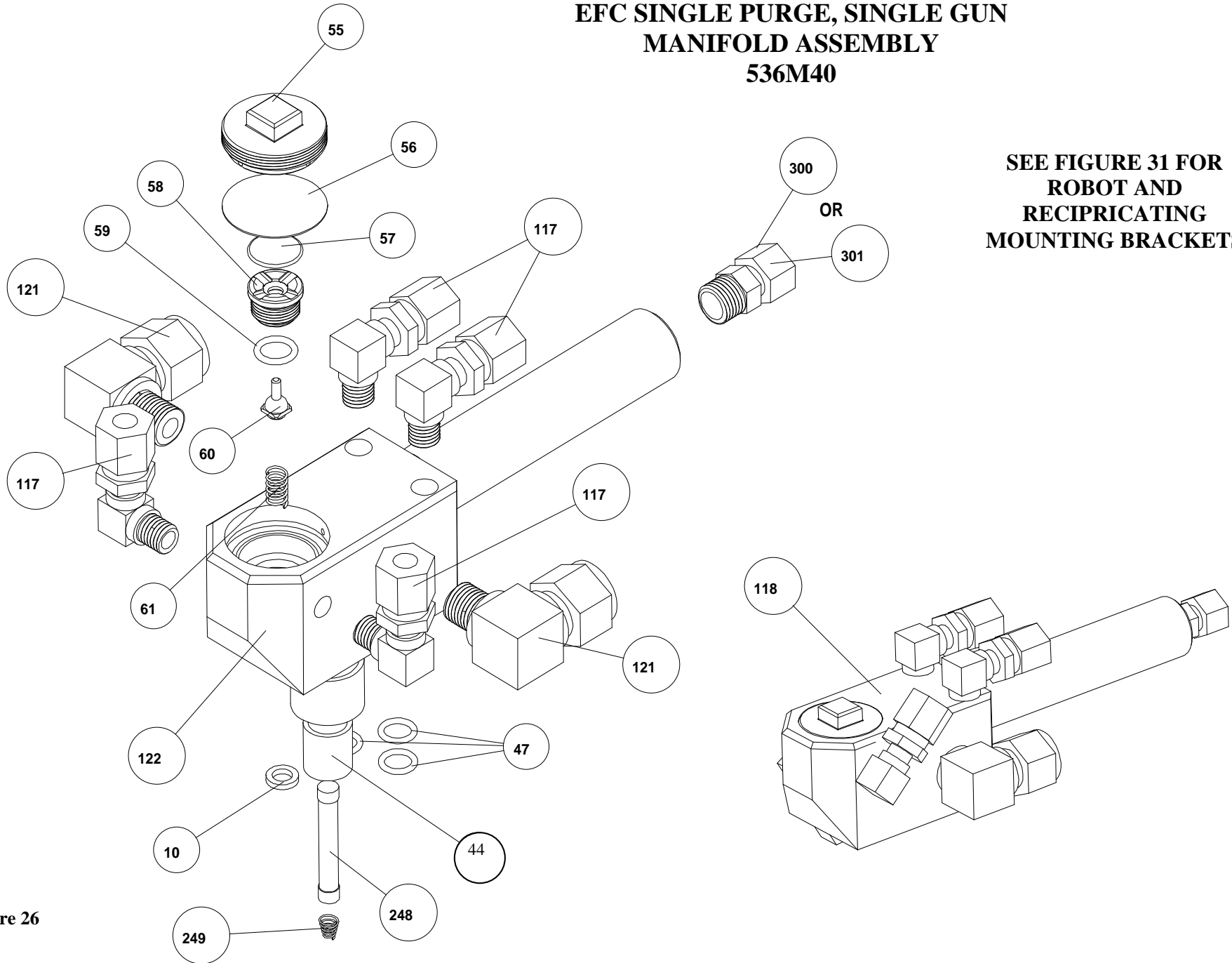

Figure 26

DESCRIPTION	ITEM #	FIG	EFC PART #	SAMES® PART #
WASHER, FLAT, TEKREZ® (CHEMICALLY RESISTANT)	10	26	252L60	82-0883-00
OUTER SLEEVE	44	26	600A40	449707
INNER SLEEVE	45	26	601A40	449706
O-RING, VITON®	47	26	8919VR	J2FTCF018
O-RING, TEKREZ® (CHEMICALLY RESISTANT)	47.1	26	8919CR	82-0410-03
VALVE COVER NUT, SQUARE	55	26	201M50M	72-0559-01
VALVE COVER NUT, 2 HOLE	55.1	26	201M50	449548
VALVE DIAPHRAGM	56	26	202M50	449549
VALVE DIAPHRAGM HOLDER	57	26	203M50	449546
SEAT, STAINLESS STEEL	58	26	211M50	742761
SEAT, COMPOSITE	58.1	26	30-1A22	N/A
O-RING, TEFLON®	59	26	1020TR	J3TTCN007
NEEDLE VALVE, STAINLESS STEEL	60	26	210M50	740511
NEEDLE VALVE, COMPOSITE	60.1	26	210M50A	N/A
VALVE SPRING	61	26	213M50	742760
FITTING, NYLON ELBOW	117	26	1814NYE	85-0153-56
MANIFOLD ASS'Y, SP, S GUN, NO REG, STD DUMP, RECIP	118	26	536M40	750280
FITTING, NYLON ELBOW	121	26	1438NYE	85-0153-63
MANIFOLD BODY, SP, S GUN, NO REG, STD DUMP, RECIP	122	26	536M40A	745002
RESISTOR, 82 MEG	248	26	RES820	740016
CONTACT SPRING	249	26	530M40S	740018
FITTING, NYLON, MOD FOR 90KV CABLE	300	26	1412NYF-S	N/A
FITTING, NYLON, MOD FOR 60-1A13 CABLE (1/4" DIA) 100KV	301	26	1414NYF-M	N/A